

CANAL DAY 2024

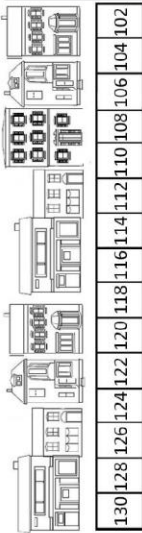

Lana's Flower Boutique



Newport Reorganizations & Preservation Society. In - Just for You & Baby Too



Carpetbagger Collectibles

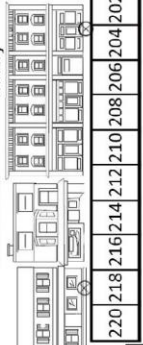

Juniata Valley Winery

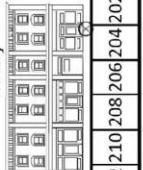

Sweet to the Soul

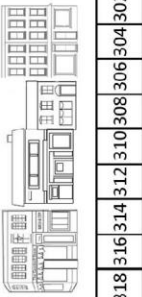

A B C D E F

Daydream Salon

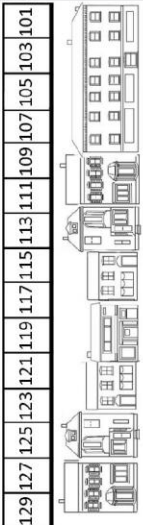

Green Acres Realty



Sharar's Grocery



PCCA Gallery



Newport Senior Center



Buffalo Brew

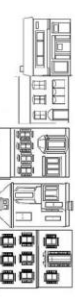

Bitting's



Map is not drawn to scale. Buildings are shown for reference only. Spaces are marked with vendor numbers.

2024 CANAL DAY VENDORS

Space	Vendor
101/ 103	Bounce House
102/ 104	Suri Alpacas of Shiloh Farm
106	Sweet Caroline
108	Pampered Chef
110	Beth Farnham for Congress
112	Edward Beaver
114	Gwen Babski
116	Practically Magic
201	Perry County Council of the Arts
202/ 204	<i>Newport Revitalization and Preservation Society</i>
203	Unbeleafably Creative
205	Artistic Image
206	Mimzy - Balloon Artist
207/ 209	Incarnation United Church of Christ
208	Boy Scout Troop 222 Newport
210	Joyess Stitchery
211	Trout Run Suds & Salvage
212	Karen Clark
213	HW Bohemian Creations
214	Newport Civic Club
215/ 217	Soap by Brooke
216	Red Hill Church of God
218/ 220	Disabled American Veterans Chapter 49
219	New Bloomfield Civic Club
221	The Church of the Nativity
222	Jill's Stills

Space	Vendor
223	YWCA of Greater Harrisburg
224	Samaritan's Purse – Operation Christmas Child
225	Simply Wood
226	Cat's Eye Magick
227	L2Kreations
228	ShaeJ Creations
229	Kate Miller Art
230	Scarlet Elf
231	Paper Pie
232	Scentsy
233	B&R Woodwork
234	Pawnee Lane Bowtique
235	Giant Food Stores
236	Newport Public Library
237	Newport Elementary PTO
238	Perry County Literacy Council
301	Renewal by Anderson
302/ 304	Mark D. Heath
303	Color Street
305	Crafty Moyer
306	Members 1st Federal Credit Union
307	Perry Valley Resin and Woodworking
308/ 310	Valley Custom Crafts
309	Hilltop Creations
311/ 313	Enchanted3D.LLC
312	ChronCrafts

Space	Vendor
314	Domestic Violence Services of Cumberland & Perry Counties
315	1st Pine Grove Church
316/ 318	TNT Dynamite Smoke Wagon
317	Central Baptist Church Outreach Committee
319 to 325	Bread of Life Outreach/ Newport Assembly of God
327	Tastefully Simple
328	Orrstown Bank
329	Perry County Chamber of Commerce
330	Perry County Republican Committee
331	Honey in the Hollow Bee Farm
332	CPRS Physical Therapy
333	Hope Eternal United Methodist Women
334	The Perry County Chapter DAR
335	D and L Creations
336	Weis Markets
337	Newport Ambulance League
338	Newport Lions Club
A	Crank Therapy
B	Perry County Animal Rescue
C	Newport Fire Company
F	Newport High School Football Team